

Date: 21.09.2022

Time 12.00

Subject: COMMUNICATION NO 2

Document No: 3.2

From : The Clerk of the Course:

To : All competitors/ Crew Members
Number of pages 3

Appendix: 1

Positioning of ONI system equipment (GPS system) in a rally vehicle

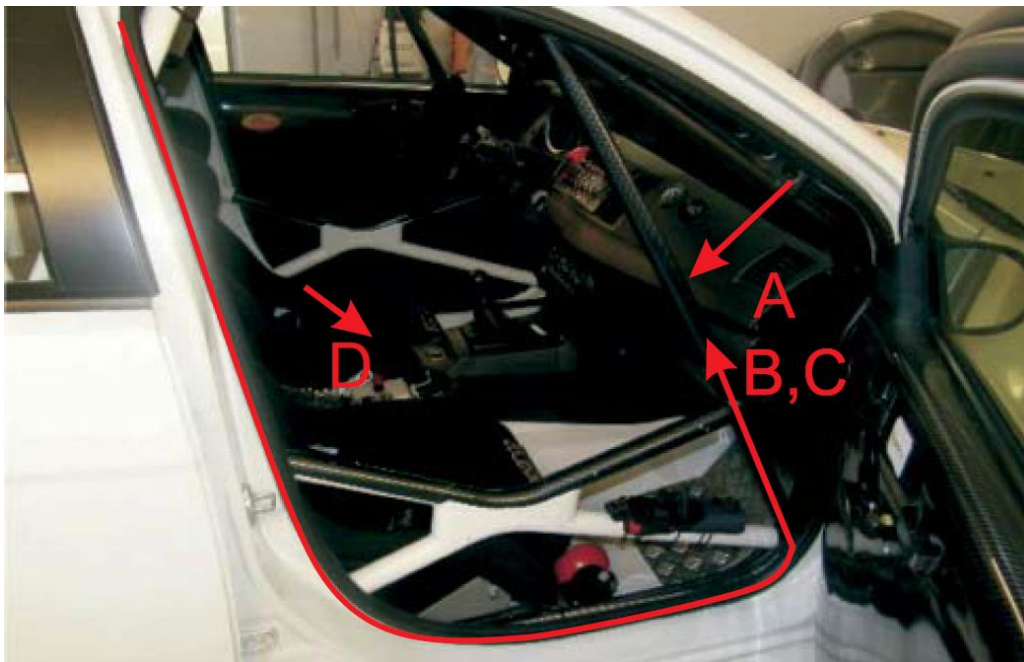

- A – Positioning of rally unit
- B – Connectors (at end of magnetic antenna cables)
- C – Connector (at end of power cable)
- D – Positioning of SOS panel

Preparation:

1. Connect the rally unit power cable wires to the vehicle battery disconnecter, either to the connectors or to the terminal block. Always observe the correct polarity of the wires (brown wire to the + pole and blue wire to the – pole). The power cable wires must not be connected directly to the vehicle battery!

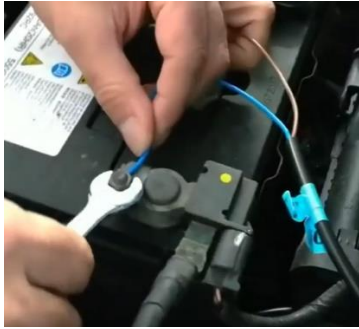

Lead through the dashboard onto the safety cage frame at the side of the co-driver (**to point B - shown on positioning picture at start of document**) so that it can be connected to the rally unit positioned at **point A**. It is also possible to connect the wires of the power cable to a power source or live feed inside the vehicle cockpit (we do not though recommend connection to intercoms).



2. Place the magnetic antenna on the roof. Lead the cables from the magnetic antenna through to the safety cage frame at the side of the co-driver (**to point C - shown on positioning picture at start of document**) leaving around 25cm reserve for connecting these cables to the rally monitoring unit **at point A** (so that the cables are not bent or deformed). Fix the cables to the frame (but not too firmly so that dismantling after the rally is easier).

3. The SOS panel must be fixed and positioned so that both members of the crew can easily reach this (in the area between the front car seats or at the side of the driver or co-driver seat). The panel is fixed by means of Velcro or by using plastic fixing strips. Inform the crew where the SOS panel is positioned.

4. The rally unit, holder and SOS panel should be installed on Friday 21.09.2022 till 12.00. Instructions for using the rally unit and SOS panel will be handed over during roadbook issuing, the unit itself will be handed over on administrative checks.

5. Once vehicles have completed the rally, they must return all monitoring equipment to the staff administrating the monitoring of the rally. If a vehicle does not complete the rally, all monitoring equipment must be returned to the rally monitoring staff as quickly as possible (and before the end of the rally).

6. Price list

Item	Cost per piece	
Rally unit w/display - NCL 20BIRally	250	EUR
SOS/OK control panel	41	EUR
Roll cage holder/clamp	70	EUR
Coupling for roll cage holder/clamp	10	EUR
Metal back-plate (for SOS/OK panel)	2,90	EUR
Combined GPS/GSM magnetic antenna	36,60	EUR
Power supply cable	4,60	EUR
NCL 21 reconnaissance unit	128	EUR
Recharging mat + EU adapter for NCL 21	15	EUR

Miha Levec
Clerk of the Course

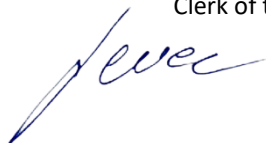

REFERENCE USER GUIDE OF THE ONI GPS SYSTEM

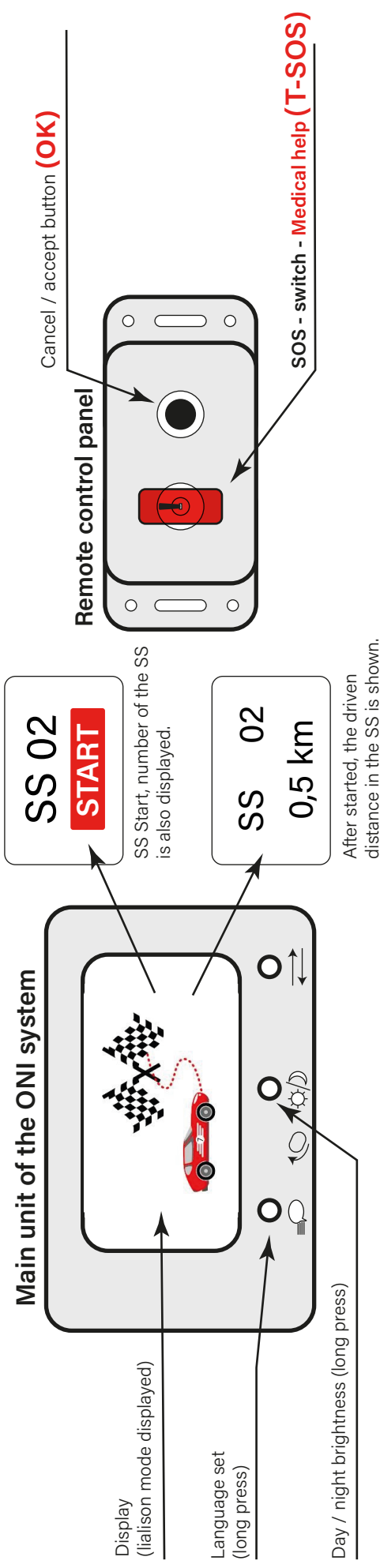

Stopped, NOT blocking

Situation:

- Puncture change on SS
- Technical issue
- Retired
- Car slided into ditch...

What to do?

- Press the **OK** when the car has stopped
- If retired inform the Rally control
- If parked on the side of the road, please use the warning triangle!
- Use the paper green OK sign if the car is damaged and visible from the SS track.

Other crews see on the GPS:

- No information is displayed on the GPS unit to the approaching crews.

Stopped, BLOCKING

Situation:

- Completely blocked road
- Car stopped in a very dangerous place (tech. issue, repair...)

What to do?

- Do **NOT** press **OK** after stopping
- Try to push the car away
- Call Rally control
- Unit is displaying, after 30 sec:

ARE YOU OK?

- **Keep displayed.** OK button should be pressed once the track is clear or you continue driving.

Other crews see:

- The Unit in the approaching car is displaying, with one beep:

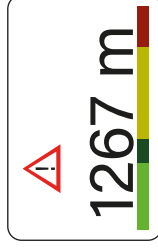

Accident

Situation:

- Accident automatically recorded by ONI unit:



What to do?

- **Medical** help needed: Use T-SOS switch, see next point
- Crew and SS track OK: Press OK
- Track blocked: Do **NOT** press OK

Other crews see:

- The Unit in the approaching car is displaying, with constant beep

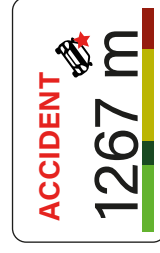

- Should the crashed crew press the OK, warning disappears.

SOS - Medical help

Situation:

- Accident - **ambulance** needed
- Calling help for other crew after arriving to crash scene
- Calling help for spectators...

What to to?

- Use the T-SOS Switch
- Call Rally control if possible
- Unit will display:



Other crews see:

- The Unit in the approaching car is displaying, with constant beep



Red flag

Situation:

- Red flag issued by the Rally controls. Unit displays, together with continuous beeping signal:



What to do?

- You are obliged to accept the flag by pressing OK, that mutes the sound alarm as well.
- Driver is obliged to decrease the speed immediately and safely continue in direction to the SS finish and/or following Marshals instructions should the road be blocked.

- **Notional time is given**