

Friday, September 7, 2023

## Bulletin 2

To: All Competitors / Crew

From: Clerk of the Course

Number of Pages: 4      Attachments: 0

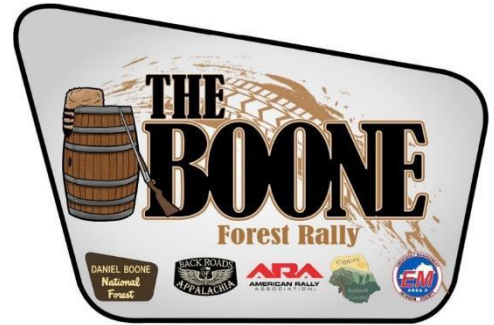

# 1 Chicanes

## A) Design

- All chicanes will be constructed using hay bales placed inside orange construction bags, with anti-cut devices along the road edge leading into and exiting the chicanes to prevent damage to the grass beside the road.
- All chicanes will be of 2 element design, with right side entry so that the first element is on the left side of the vehicle.
- All hay bales and anti-cut devices used in the construction of the chicane will be considered part of the chicane. Striking and displacing any hay bale or anti-cut device will be considered for penalty under RCR 1.3.2.e.

## B) Locations

- Chicane #1 will be located on Stages #1, #3 (*The Anderson*) at 0.85 miles from the starting point of stages.
- Chicane #2 will be located on Stages #2, #4, #5 (*The Strong*) at 6.36 miles from the starting point of stages.
- Chicane #3 will be located on Stages #2, #4, #5 (*The Strong*) at 6.45 miles from the starting point of stages.

## C) Layout

### Chicane #1

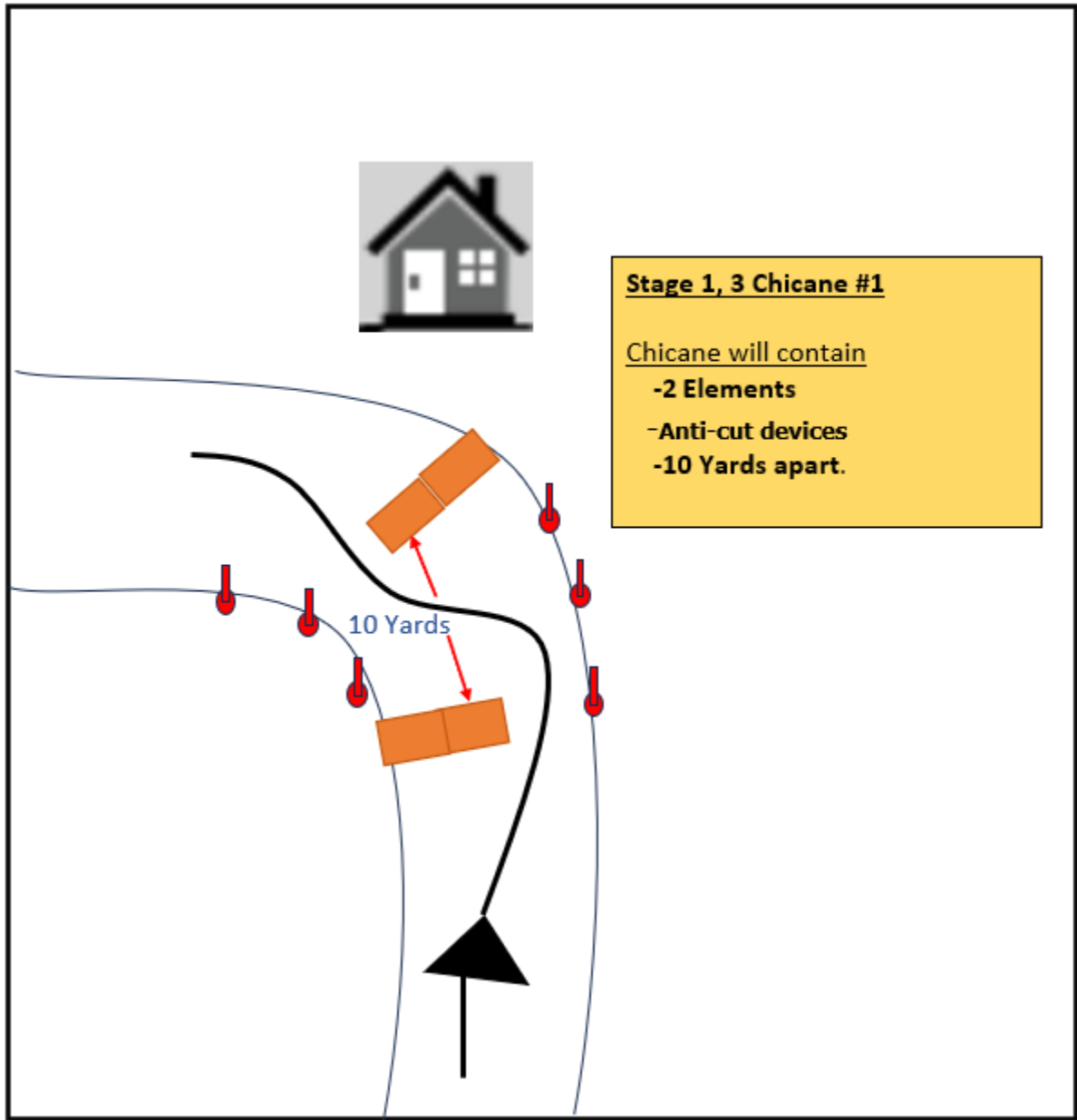

# Chicane #2

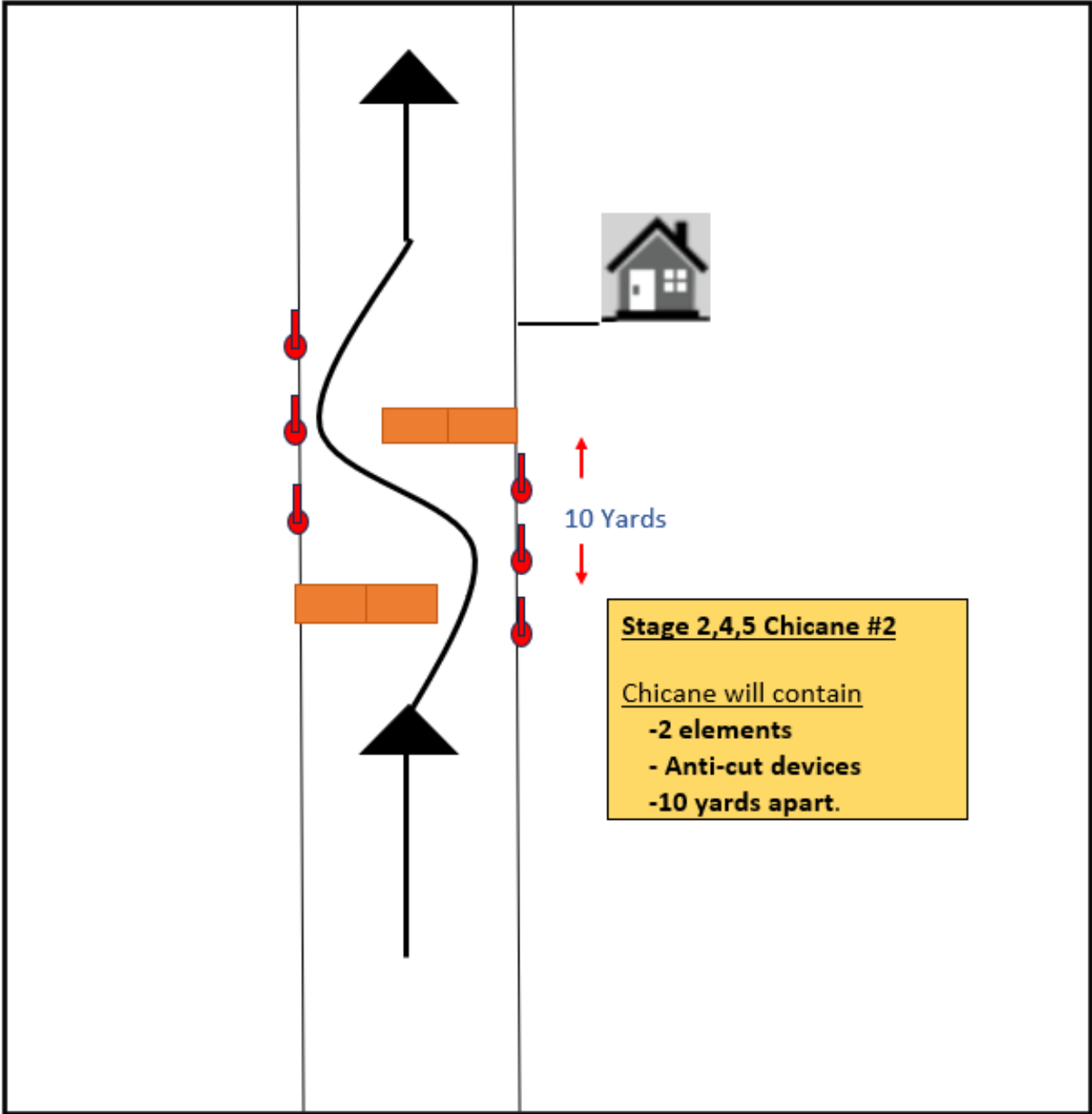

# Chicane #3

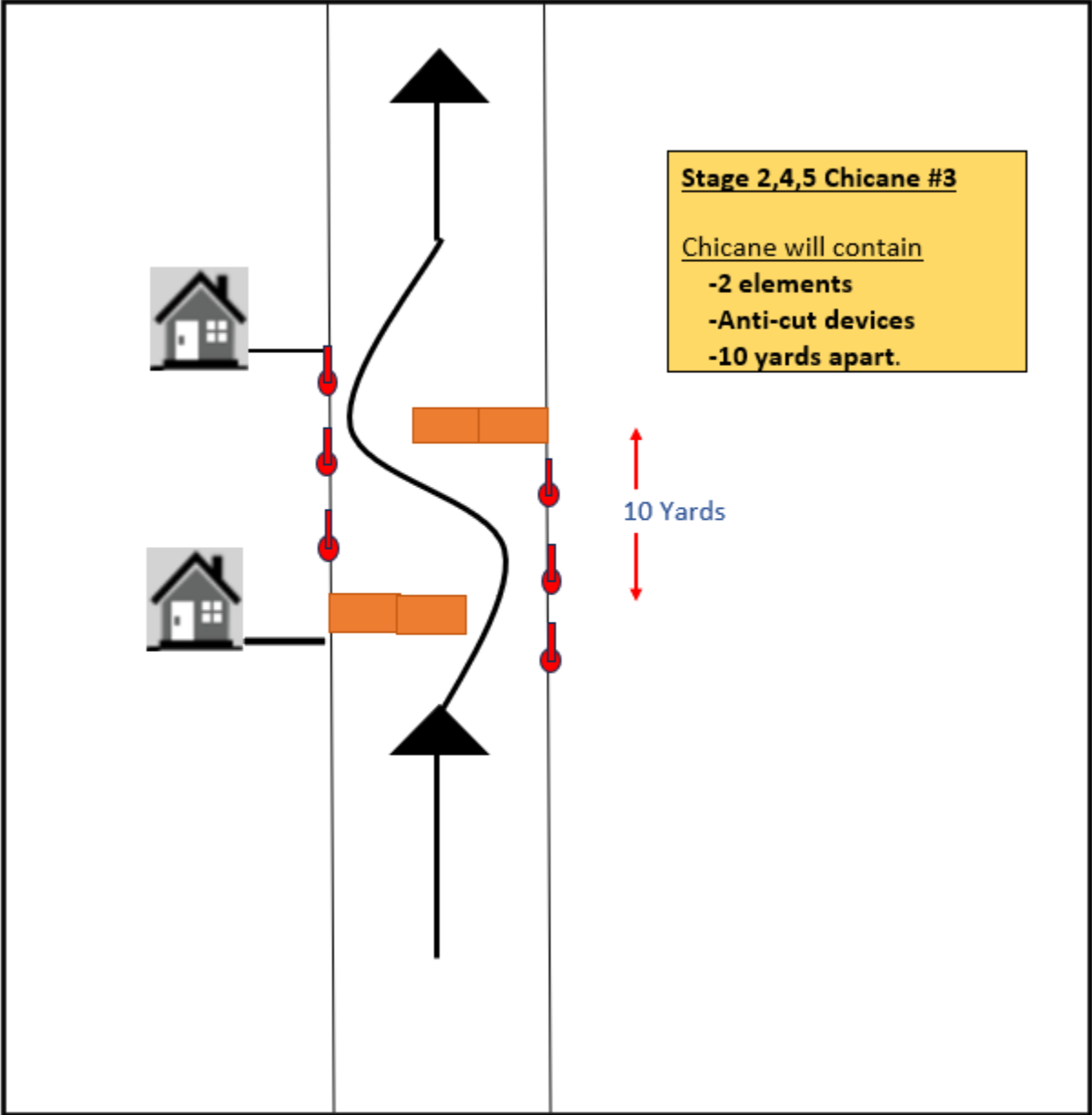

Brian Anderson  
Clerk of the Course