

**SUPPLEMENTARY REGULATION
FIM EUROPE SUPERENDURO CUP
03 January 2026 – Riesa (GER)
IMN 424/02**

ANNOUNCEMENT

The Club **MSV Riesa e.V. im ADAC** and the promotion company **Agencja Sport Up** are organising the 2nd round of the 2026 FIM Europe SuperEnduro Cup on behalf of the **DMSB** (Federation). The event will be held in accordance with the Sporting Code of the FIM together with relevant Appendices, Regulations, FIM Europe SuperEnduro Cup Regulations, these Supplementary Regulations, and any final instructions, approved by the FIM Europe Referee. The event must respect the FIM Environmental Code.

Date of the Event: **03.01.2026**

Venue: **WT Energiesysteme (WTE) Arena, Riesa (Germany)**

Location: <https://maps.app.goo.gl/7V8z1MyFUMRUPTwD9>

IMN no. 424/02 FIM Europe SuperEnduro Cup

ACCESS

Nearest airport:	Dresden 60km (50 min.), Leipzig 97km (1 hour), Berlin-BER 175km (2 hours)		
Motorway:	A13 Exit No. 20	Motorway:	A14 Exit No. 34
National road:	B98 (from A13)	National road:	B169 (from A14)
Nearest town:	Riesa	at km:	1km from Centre

Organiser:

Name (Club):	MSV Riesa e.V. im ADAC
Address:	Karl-Marx-Straße 11
City	01109 Dresden
Tel. no:	+49-700-67874372
E-mail:	rennbuero@msv-riesa.de

Executive Organizer:

Name:	Eventmanufaktur Auerswald
Address:	Am Hang 2
City	09394 Hohndorf
Tel. no.:	+49-162-7977549
E-mail:	danielauerswald2104@gmx.de

Secretariat of the event:

Name:	MSV Riesa e.V. im ADAC	E-mail:	rennbuero@msv-riesa.de
Address:	Am Sportplatz 5	City:	01589 Riesa
Tel. no.:	+49-700-67874372	Website:	www.msv-riesa.de

Welcome Center – Opening hours

02.01.2026	13:00 to 21:00	03.01.2026	08:00 to 18:00
-------------------	----------------	-------------------	----------------

**IT IS COMPULSORY TO USE AN ENVIRONMENTAL MAT AT ALL FIM SUPERENDURO VENUES
A DEDICATED REFUELLING AREA WILL BE PROVIDED BY ORGANISER**

1. ENTRIES

Entry fee for all the riders (FIM Europe) is 120 EUR (transponder pack included) paid to the promoter. All entries must be received before 7 days prior the start of the Event. The entry fees for late entries will be 150 EUR.

No entries will be accepted after 23:59 on the Wednesday prior the start of the Event.

The deposit for the transponder is EUR 100 and is paid to the timekeeping company. The full amount of the deposit will be given back when the transponder is returned.

Entries must be made by an electronic entry form available on the site <https://superenduro.org/for-riders/>. All other information relating to the riders, team, sponsor and the brand of the machine shall be completed.

Contact: Magdalena Borodeńko
email: m.borodenko@sportupagencia.pl
WhatsApp: +48 507 582 509

Following championship will be organized:

- FIM Europe SuperEnduro Cup

2. RIDERS LICENCES

For each Event of the season, riders must have a valid FIM/FIM Europe Rider Licence as follows:

- FIM Europe Enduro Championship Licence or
- FIM Europe Promotional licence (annual or one event licence) or
- FIM Enduro World Championship & FIM ISDE (World Trophy & Junior World Trophy) (Annual) or
- FIM Enduro Junior / Youth / Women/ ISDE + Women & Clubs / Hard Enduro Junior (Annual) or
- FIM SuperEnduro World Championship / FIM Junior & Women's Superenduro World Cups (Annual)

3. ADMINISTRATIVE AND TECHNICAL CONTROL

The administrative control will take place:

Date:	02.01.2026	Time:	17:30 – 19:30	Place:	Room No. 1 (appendix)
--------------	------------	--------------	---------------	---------------	-----------------------

The technical control will take place:

Date:	02.01.2026	Time:	18:00 – 20:00	Place:	Room No. 10 (appendix)
--------------	------------	--------------	---------------	---------------	------------------------

1. MEETING WITH THE ORGANISERS AND RIDERS' BRIEFING

The meetings with the Organisers will take place on:

Date:	02.01.2026	Time:	18:00	Place:	Room No. 7 (appendix)
Date:	03.01.2026	Time:	09:00	Place:	Room No. 7 (appendix)
Date:	03.01.2026	Time:	21:30	Place:	Room No. 7 (appendix)

The Rider's Briefing will take place:

Date:	03.01.2026	Time:	09:30	Place:	Room No. 22 (appendix) TV & Press-Container
--------------	------------	--------------	-------	---------------	--

Rider's Briefing is compulsory to all riders. The Briefing will be held in English language.

2. SCHEDULE AND FORMAT OF THE EVENT

The schedule of the event is according to the 2025 FIM SuperEnduro World Championship Regulations.

START	END	TIME SCHEDULE (DATE)	TIME/LAPS
16:30	16:45	Track Test	15 Min
18:00	18:30	1 st Meeting with the Officials and the Organiser	30 Min
17:30	19:30	Administration Control	120 Min
17:00	20:00	Technical Control	120 Min
19:00	19:20	Press Conference	20 Min

START	END	TIME SCHEDULE (DATE)	TIME/LAPS
08:00	09:00	Track Officials Meeting with Marshals and Medical delegates	
09:00	09:30	2nd Official FIM Meeting	
09:30	10:00	Rider Briefing SEWC + SEEC	30 min
10:00	15:30	Arena Open (only for Training Tickets)	
10:15	10:22	Free Practice Europe SEEC Group A + start practice	5 Min
10:22	10:29	Free Practice Europe SEEC Group B + start practice	5 Min
10:29	10:36	Free Practice Youth A + start practice	5 Min
10:36	10:43	Free Practice Youth B + start practice	5 Min
10:43	10:52	Free Practice Junior A + start practice	6 Min
10:52	11:01	Free Practice Junior B + start practice	6 Min
11:01	11:10	Free Practice SEWC Prestige Grading list + Start practice	6 min
11:10	11:19	Free Practice SEWC Prestige Non-grading list + Start practice	6 min
11:19	12:15	Break/Track maintenance	56 min
12:15	12:24	Timed Qualification Europe SEEC Group A	7 Min
12:24	12:33	Timed Qualification Europe SEEC Group B	7 Min
12:33	12:43	Free Practice II SEWC Prestige Grading list	8 Min
12:43	12:52	Timed Practice SEWC Prestige Non-grading list	8 Min
12:52	13:01	Timed Qualification SEWC Youth A	7 Min
13:01	13:10	Timed Qualification SEWC Youth B	7 Min
13:10	13:20	Timed Qualification SEWC Junior Group A	8 Min
13:20	13:30	Timed Qualification SEWC Junior Group B	8 Min
13:30	13:38	1st Qualification Race Prestige	5 Min +1Lap
13:38	13:46	Last Chance Race Europe SEEC A	5 Min +1Lap
13:46	13:54	Last Chance Race Europe SEEC B	5 Min +1Lap
13:54	14:02	Last Chance Race SEWC Youth A	5 Min +1Lap
14:02	14:10	Last Chance Race SEWC Youth B	5 Min +1Lap
14:10	14:18	Last Chance Race SEWC Juniors	5 Min +1Lap
14:18	14:26	Last Chance Race SEWC Prestige	5 Min +1Lap
14:26	14:40	Break / Track Maintenance	14 Min
14:40	14:49	Timed Practice Europe SEEC for starting order	7 Min
14:49	14:58	Timed Practice SEWC Youth for starting order	7 Min
14:58	15:08	Timed Practice SEWC Junior for starting order	8 Min
15:08	15:18	Timed Practice SEWC Prestige for starting order A	8 Min
15:18	15:28	Timed Practice SEWC Prestige for starting order B	8 Min
16:00		Arena Door Opening	

The final time schedule will be published in due course. The format of the race, according to FIM Europe SuperEnduro Cup Regulations is enclosed with this Supplementary Regulation.

3. RIDERS ADMITTED

The riders admitted will be established according to Art. 4 of FIM Europe SuperEnduro Cup Regulations.

The maximum number of riders accepted in FIM Europe class is: 28

4. STARTING PROCEDURE

The starting procedure will be established according to Art. 6.8 of FIM Europe SuperEnduro Cup Regulations.

5. PADDOCK

Paddock is located inside the Arena, close to starting gates.

Dedicated refueling area outside the Arena will be provided and indicated by organizer.

The use of an environmental mat is always mandatory, also in the case of electric generators or other generators. It is compulsory for electric bikes to use an electrical insulation mat. Failure to comply with this obligation is subject to a disciplinary penalty of 100 EUR. In the event of non-payment of the penalty or failure to use the mat after the above-mentioned penalty has been imposed, the rider will be excluded from the event.

6. BIKE WARM-UP AREA

This area will be designated near the paddock, outside. It is strictly forbidden to warm-up the bikes in any other location, especially at paddock inside building. When riding during warming-up the rider is obliged to wear a helmet. Riding on the green areas is forbidden.

7. INSURANCE

By endorsing the application form for entry, the FNM of the rider certifies that the rider is insured in accordance with the FIM Europe requirements.

The organizer has contacted third party insurance in accordance with Art. 110.1 of the FIM Europe Sporting Code. This insurance includes a guarantee of the minimum amount as stipulated by the FIM Europe Management Council. The Insurance comes in effect 2 days before the first practice and ends after Prize giving ceremony of the meeting. The organizer disclaims all responsibility for damage to a motorcycle, its accessories and components arising out of an accident, fire or other incident.

8. SIGNALING ZONE

The Signaling Zone is only available to team members actively taking part in the race.

9. RESULTS

The classification will be established according to Art. 6.9. of FIM Europe SuperEnduro Cup Regulations.

10. FUEL

According to FIM Specifications.

11. PRIZE-GIVING CEREMONY

Ceremony will be held straight after second Final according to time schedule close to starting gates. Riders who qualify for prizes are invited to attend the prize-giving ceremony. If invited, attendance to the prize giving ceremony or press conference is compulsory.

12. PROTESTS AND APPEALS

Any person or group of persons (rider, entrant, manufacturer, official, etc.), recognized by the FIM and concerned by a decision taken under the authority of the FIM Europe, may ask for redress for the consequences of that decision.

Protest must be lodged according to the FIM Europe Disciplinary and Arbitration Code and the Supplementary Regulations and be accompanied by a fee of € 350,- or equivalent amount in local

currency, returnable if the protest is justified.

Protests against the admission of a registered rider, team or machine must be presented before the riders leave the waiting zone in order to participate in the practice.

Protests against results must be presented to the International Jury within 30 minutes following the publishing of the results.

An appeal can be made to the FIM Europe Disciplinary Commission against a decision of the International Jury.

Protest entailing a fuel control: See FIM Europe rulebooks.

13. INTERPRETATION OF THE SUPPLEMENTARY REGULATIONS

The interpretation of this regulation rests entirely with the Referee. In case of dispute, regarding the interpretation or if there is any difference between the two official texts, the English text will prevail.

14. ACCOMMODATION PROPOSALS

(1st choice)

Hotel Name:	Mercure Hotel Riesa Dresden Elbland
Address:	Bahnhofstraße 40, 01587 Riesa
Tel. no.:	+49-3525-709-0
Email:	h2126@accor.com
Comments:	

(2nd choice)

Hotel Name:	Wettiner Hof
Address:	Hohe Straße 4, 01587 Riesa
Tel. no.:	+49-3525-718-0
E-mail:	info@wettiner-hof.de
Comments:	

15. OFFICIAL NOTICE BOARD / SPORTITY

The Official Notice Board is available on Sportity. The users need to download the Sportity app from AppStore or Google Play and insert the channel's password.



16. OFFICIALS

FIM Representative:			
FIM Referee:	John Colins	FIM Licence:	15640 / 4450
FIM Europe Referee:	Pavol Sas	FIM Licence:	50005
Clerk of the Course:	Heiner Schmidt	FIM Licence:	
Assist. Clerk of the Course:	Kevin Olbrich	FIM Licence:	
FIM Technical Director:	Peter Radoczi	FIM Licence:	14942
FMNR Technical Steward:	Gerd Hilbrands	FIM Licence:	
Course Inspector:	Tbc	FIM Licence:	



Chief Medical Officer:	Jan Kolomaznik		
FMNR Sustainability Steward:	Olaf Zehl	FIM Licence:	14810
Timekeeper:	Grzegorz Ostrowski - Motoresults	FIM Licence:	16726
Press Officer:	Thorsten Horn		
Secretary of the Jury:	Kevin Olbrich – MSV Riesa e.V. im ADAC		
Promoter:	Tomasz Gagat – Agencja Sport Up		
Event Organizer:	Agencja Sport Up		

RACE FORMATS

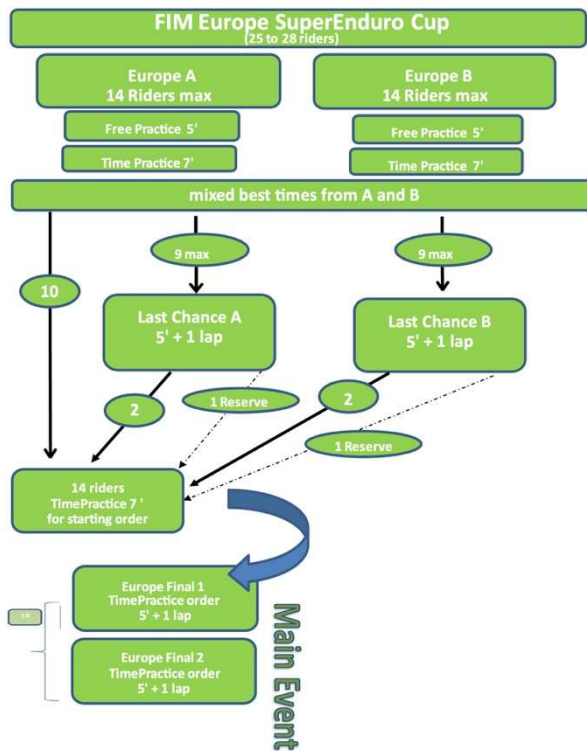
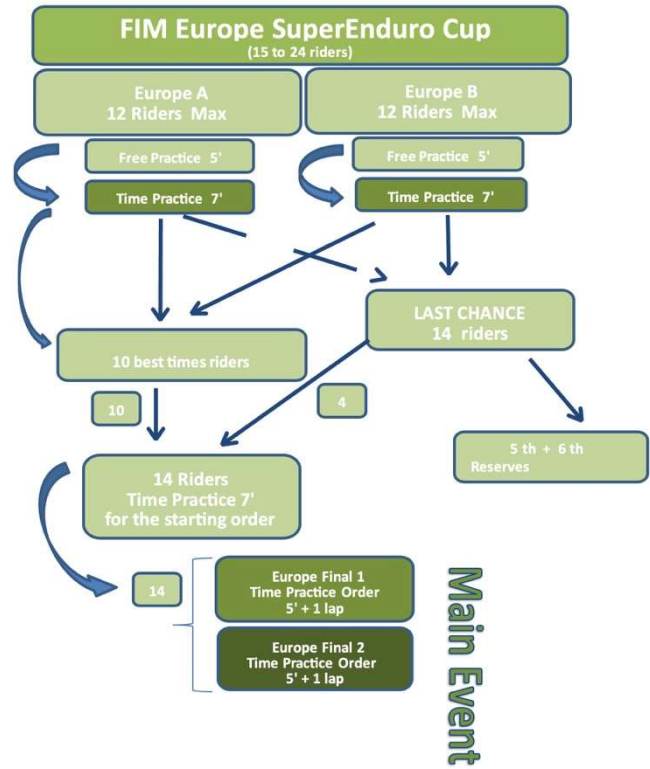
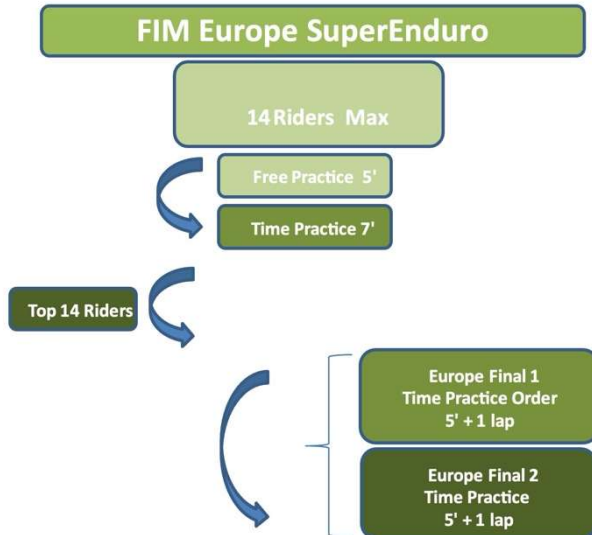

WT Arena: Inside

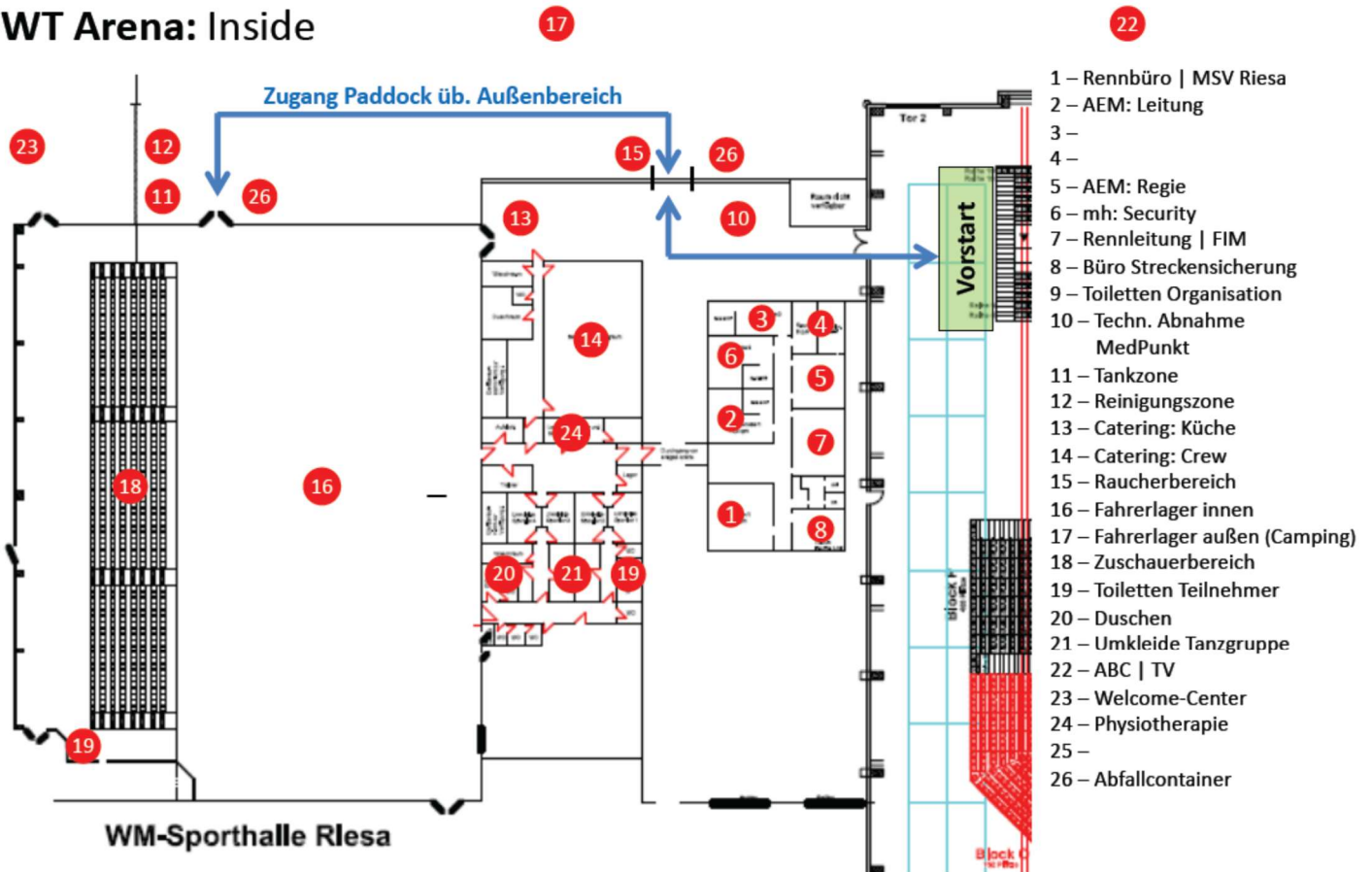

WT Arena: Outside

